

**1 Bedroom 1 Bath**  
**second floor**

**906 Square Feet**

**Starting at \$980**

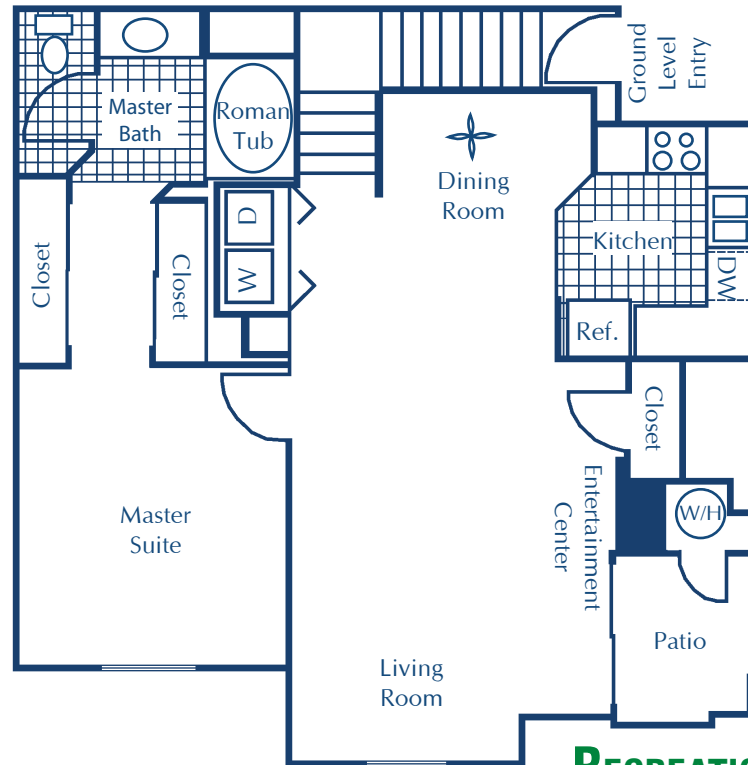

## INTERIOR FEATURES

- **DIRECT-ACCESS INTERIOR STAIRWELL ENTRANCE**
- **BUILT-IN ENTERTAINMENT CENTER**
- **FULLY APPOINTED KITCHEN WITH CUSTOM CABINETRY**
- **DECORATIVE CERAMIC TILE KITCHEN, FOYER AND BATHS**
- **FULL-SIZE WASHER AND DRYER**
- **RELAXING ROMAN TUB**
- **SPACIOUS WALK-IN CLOSET**

## RECREATIONAL FEATURES

- **BILLIARD ROOM**
- **MEDIA LIBRARY WITH GAME TABLES**
- **FITNESS CENTER**
- **AEROBIC STUDIO**
- **AUTOMATED GATE ACCESS**
- **REFRESHING POOL AND SPA**
- **LIGHTED TENNIS COURT**
- **NATURE WALKING TRAILS**
- **ADJACENT TO SUMMERLIN PARK**

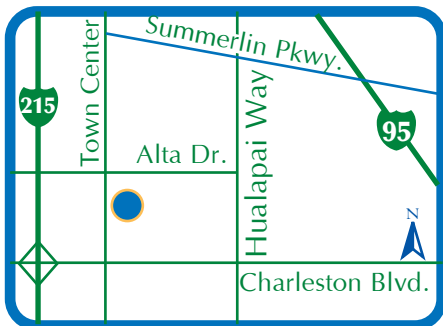

**MON-SUN: 8AM-6PM**

**PRICES SUBJECT TO CHANGE WITHOUT NOTICE**

**CANYON VILLAS**  
**650 SOUTH TOWN CENTER DRIVE**  
**LAS VEGAS, NV 89144**

**PHONE: 702.360.2427**  
**FAX: 702.360.2572**

**WWW.CANYONVILLASAPARTMENTS.COM**